

Rack Component Support System

(patent pending)

Instructions

call (800)822-STAR (7827)

or, go to http://www.starcase.com/rack_component_support_system.htm
for all the details

Step 1

Fasten curl bracket to rack rails directly perpendicular to component, drawer, etc. Use two rack screws to fasten the curl brackets.

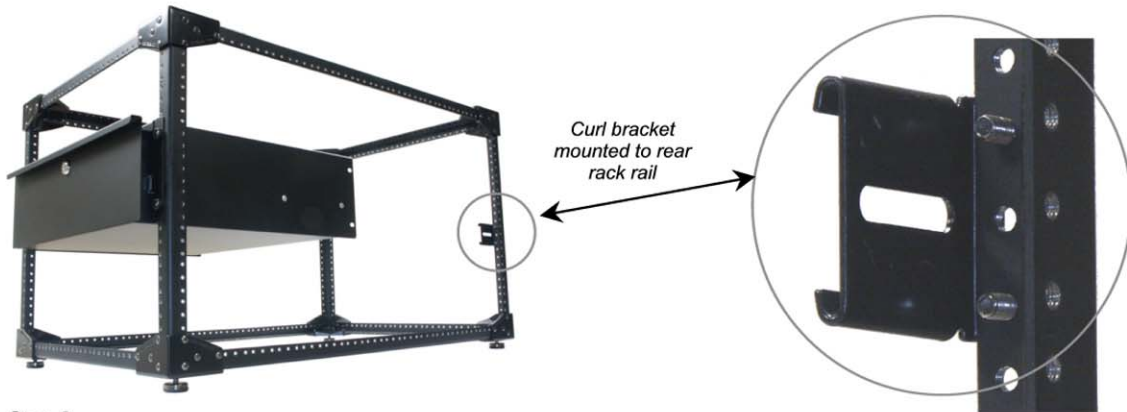

Step 2

Using the 10-32 screws and keps nuts, loosely fasten the link strip to the curl bracket and also to the component, drawer, etc.

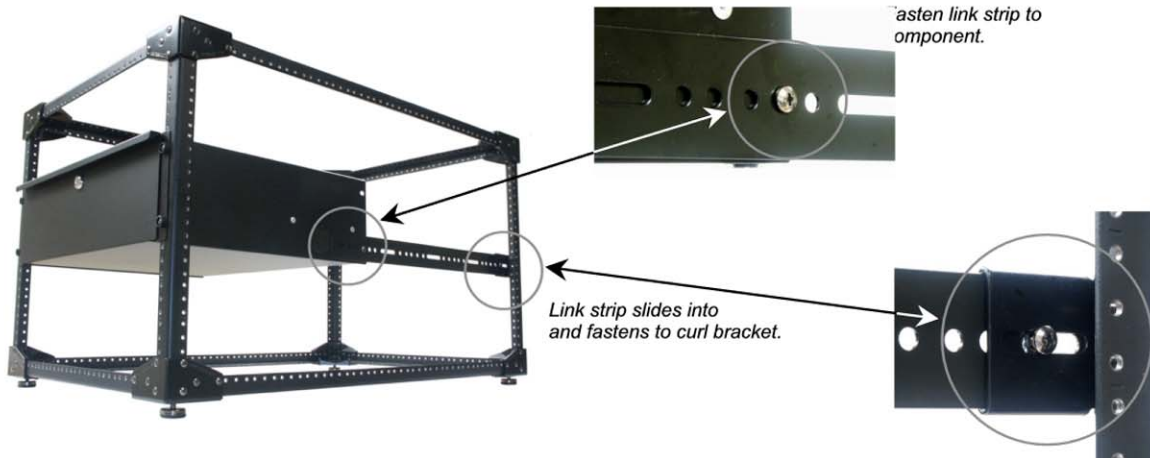

Step 3

For devices that may need additional support. For this application, use of link strips in tandem creates a cantilever effect to add greatly to the support capability of the curl brackets and link strip supports.

